

1436/5.20.3,5.3

DESCRIPTION

TECHNICAL DATA AND DIMENSIONS

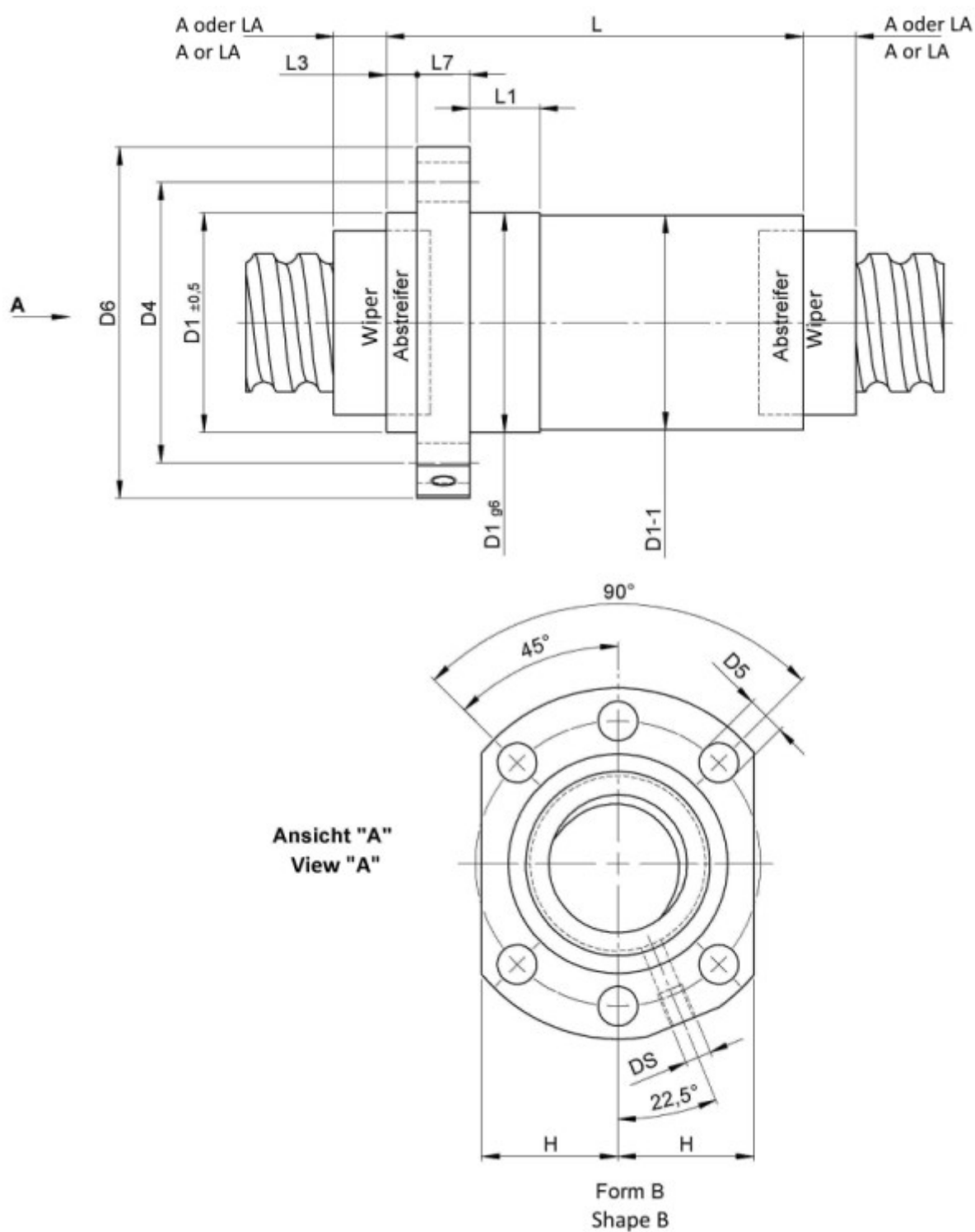

Series			1436	Dynamic load capacity	[kN]	Ca	12,10
Nominal diameter	[mm]	dN	20	Static load capacity	[kN]	C0a	16,70
Lead	[mm]	P	5	Ball circles		i	1x3
Additional wiper extensions for combination wipers	[mm]	LA	9	Ball diameter	[mm]	dW	3,5
Pilot Length	[mm]	L1	10	DN-value			82000
Pilot diameter	[mm]	D1	36	No. of starts			1
Pilot diameter tolerance	[mm]		g6	Friction torque FROM	[Ncm]		1,5
Bolt circle diameter	[mm]	D4	47	Friction torque TO	[Ncm]		13,9
Flange hole diameter		D5	6,6	Accuracy			T
Lube hole	[mm]	DS	M6	Nut length	[mm]	L	55
Flange diameter	[mm]	D6	58	Wiper extension	[mm]	L3	6
Flange flat dimension	[mm]	H	22	Flange thickness	[mm]	L7	10

August Steinmeyer GmbH & Co. KG | Riedstraße 7 | 72458 Albstadt | Phone +49 (0) 7431 1288-0 | Fax +49 (0) 7431 1288-89 | info@steinmeyer.com

Drive Technology, Ball Screws, Precision Ball Screws, Miniature Ball Screws, Ultra Thrust Ball Screws, Rotating Nuts, Cooled Ball Screws, Precision Lead Screws, Differential Rolled Screws, Rolled Ball Screws