

2422/30.16.389.471

DESCRIPTION

- Nut Series 2422 with [end cap ball return](#), Flange single nut with 4-point-contact, with standard synthetic wipers on both ends
- Nut shape design for assembly by flange
- Multiple start ball thread, ground execution according to accuracy class P1 - P5
- Miniature ball screws also available with axial play



TECHNICAL DATA AND DIMENSIONS

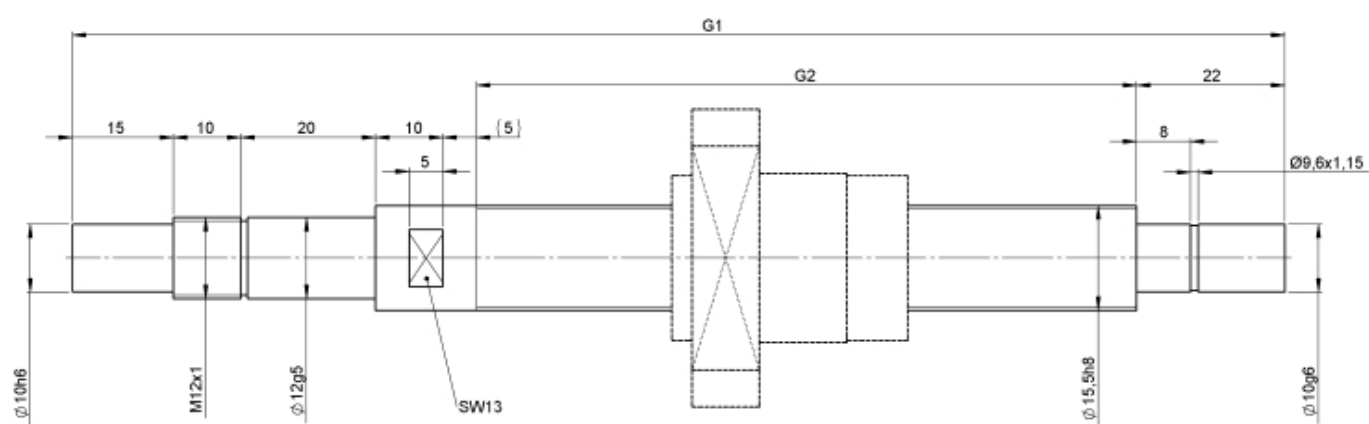
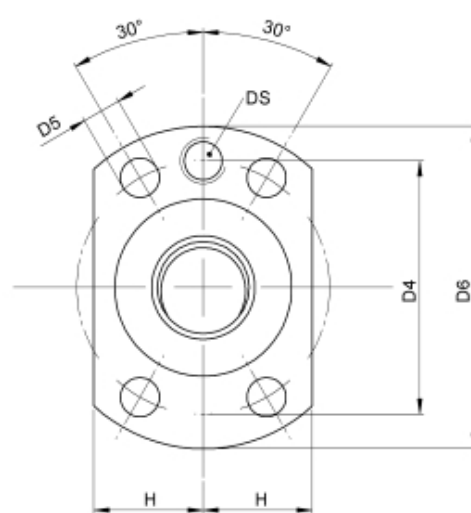

Series		2422		Nut length	[mm]	L	38
Nominal diameter	[mm]	dN	16	Wiper extension	[mm]	L3	12
Lead	[mm]	P	30	Flange thickness	[mm]	L7	10
Ball circles		i	1+1	Dynamic load capacity	[kN]	Ca	6,10
Ball diameter	[mm]	dW	3,5	Static load capacity	[kN]	C0a	7,90
DN-value			160000	Pilot Length	[mm]	L1	5
No. of starts			2	Pilot diameter tolerance	[mm]		g6
Pilot diameter	[mm]	D1	32	Flange hole diameter		D5	5,5
Bolt circle diameter	[mm]	D4	42	Flange diameter	[mm]	D6	52

August Steinmeyer GmbH & Co. KG | info@steinmeyer.com

Drive Technology, Ball Screws, Precision Ball Screws, Miniature Ball Screws, Ultra Thrust Ball Screws, Rotating Nuts, Cooled Ball Screws, Precision Lead Screws, Differential Rolled Screws, Rolled Ball Screws