

Technical Information December 2021

Optimization of ball return systems in the Miniature Ball Screw Range Standard for all single-thread versions with pitch \leq half nominal \varnothing

Previous version -
Nut design with brass deflector systems



New nut design -
Nut design with PEEK deflector systems

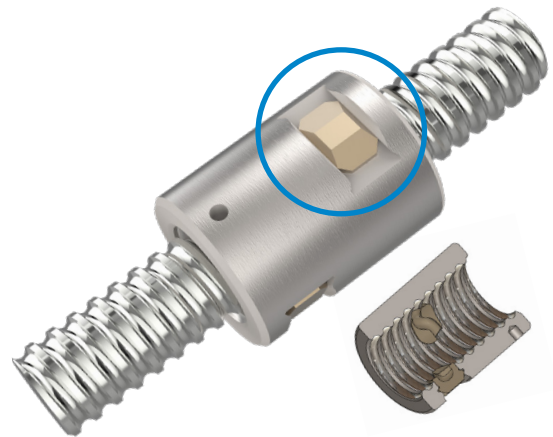

Through Steinmeyer's ongoing investments in continuous product improvements our Miniature Ball Screws with track-to-track ball returns now include new "PEEK" deflector systems.

Field of application:

All standard single start threads with pitch \leq half x nominal screw dia.

Advantages:

- Significantly improved running properties
- Superior screw dynamics as the internal rolling elements (balls) motion more smoothly through their transitional ball paths / load zones.
- High manufacturing accuracy due to improved alignment and clean positioning in the nut.

Technical data PEEK

Key environmental / resistant to:

- Temperatures to 250 C°
- Daylight and UV light
- Gamma and X-ray radiation
- Hydrolysis and superheated steam

High chemical resistance to:

- Oils
- Gasolines
- Greases
- Cooling lubricants

Excellent wear resistance.